

Meriwether County, GA

Summary

Parcel Number 082 055
Location Address 11905 ROOSEVELT HWY
Legal Description H/1 AC/LL 177 8TH
(Note: Not to be used on legal documents)
Class R3-Residential
(Note: This is for tax purposes only. Not to be used for zoning.)
Zoning
Tax District MERIWETHER COUNTY (District 01)
Millage Rate 34.526
Acres 1
Neighborhood MERIWETHER W CENTRAL (MW010)
Homestead Exemption No (S0)
Landlot/District N/A

[View Map](#)



Owner

WEST DEKLE PROPERTY SOLUTIONS LLC
 2146 ROSWELL ROAD
 SUITE 108-866
 MARIETTA, GA 30062

Rural Land

Type	Description	Calculation Method	Soil Productivity	Acres
RUR	Small Tract	Rural	3	1

Residential Improvement Information

Style 2020 Single Family
Heated Square Feet 1613
Interior Walls Sheetrock
Exterior Walls Masonry (brick)
Foundation Masonry
Attic Square Feet 0
Basement Square Feet 0
Year Built 1960
Roof Type Asphalt Shingles
Flooring Type Hardwood
Heating Type Central Heat/AC
Number Of Rooms 6
Number Of Bedrooms 3
Number Of Full Bathrooms 1
Number Of Half Bathrooms 1
Number Of Plumbing Extras 2
Value \$168,300
Condition Average
House Address 11905 ROOSEVELT HWY

Accessory Information

Description	Year Built	Dimensions/Units	Identical Units	Value
*Site Improvement C Grade	2007	1x1 / 1	1	\$3,500

Sales

Sale Date	Deed Book / Page	Plat Book / Page	Sale Price	Reason	Grantor	Grantee
10/27/2023	1040 203	25 140	\$110,000	Fair Market Value	BUCHANAN MARGARET PHILLIPS	WEST DEKLE PROPERTY SOLUTIONS LLC
8/31/2023	1035 450		\$0	Estate Sale	PHILLIPS J VERNON ESTATE	BUCHANAN MARGARET PHILLIPS
1/1/1953	51 0300		\$0	Non-Market		PHILLIPS J VERNON

Valuation

	2024	2023	2022	2021	2020
Previous Value	\$90,000	\$90,000	\$90,000	\$90,000	\$90,000
Land Value	\$17,000	\$17,000	\$17,000	\$17,000	\$17,000
+ Improvement Value	\$168,300	\$69,500	\$69,500	\$69,500	\$69,500
+ Accessory Value	\$3,500	\$3,500	\$3,500	\$3,500	\$3,500
= Current Value	\$188,800	\$90,000	\$90,000	\$90,000	\$90,000

Photos



Sketches

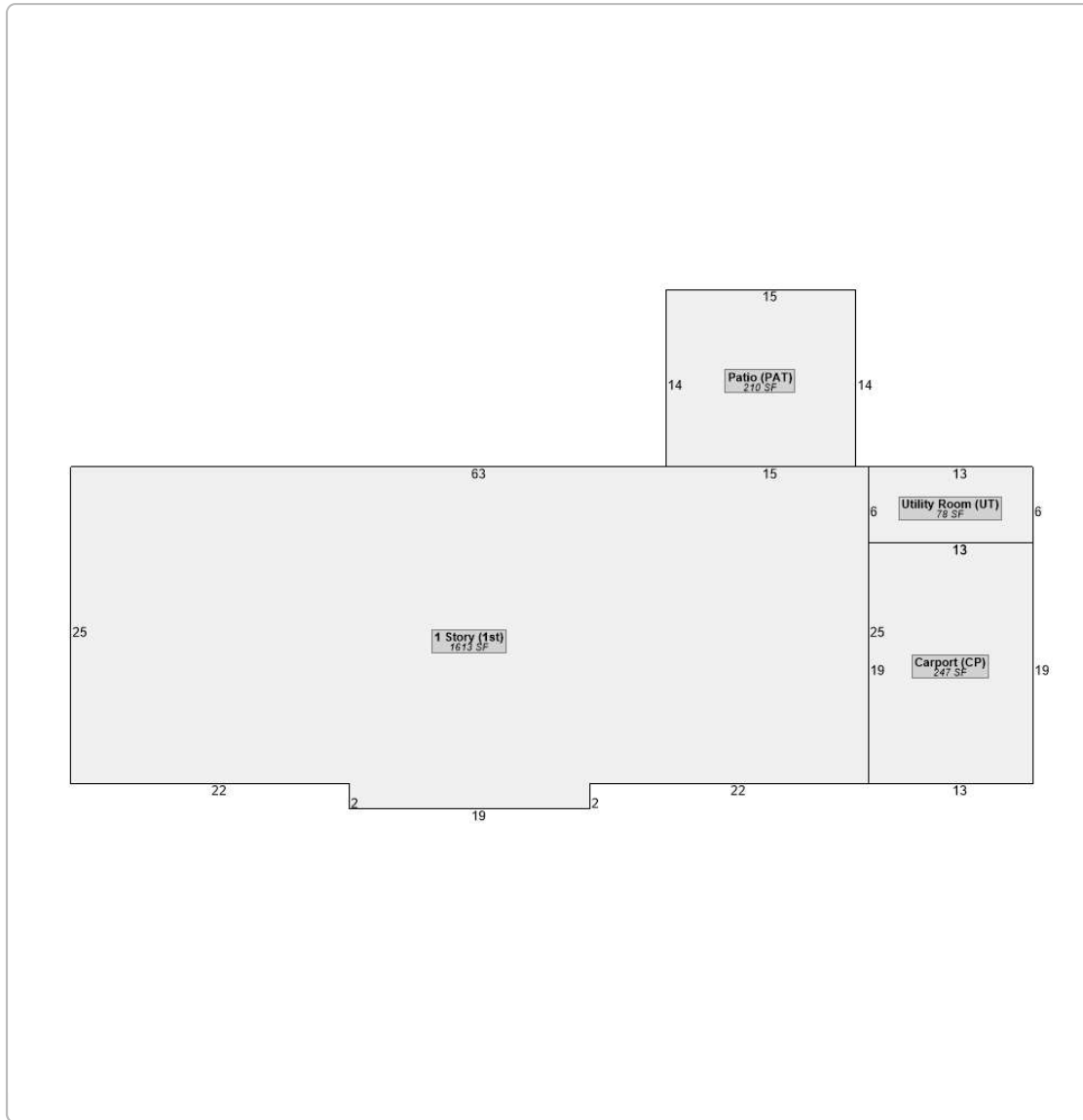

No data available for the following modules: Land, Conservation Use Rural Land, Commercial Improvement Information, Mobile Homes, Prebill Mobile Homes, Permits.

The Meriwether County Assessor makes every effort to produce the most accurate information possible. No warranties, expressed or implied are provided for the data herein, its use or interpretation. The assessment information is from the last certified tax roll. All other data is subject to change.

[User Privacy Policy](#) | [GDPR Privacy Notice](#)
Last Data Upload: 9/26/2024, 5:18:13 AM

Contact Us

